

LED

475 ALTERA



A softly glowing fixture that provides a pleasing and warm feeling. Simple to install, the fixture is perfect for multi-family complexes, healthcare facilities and office buildings.

475 ALTERA

LED

TYPE

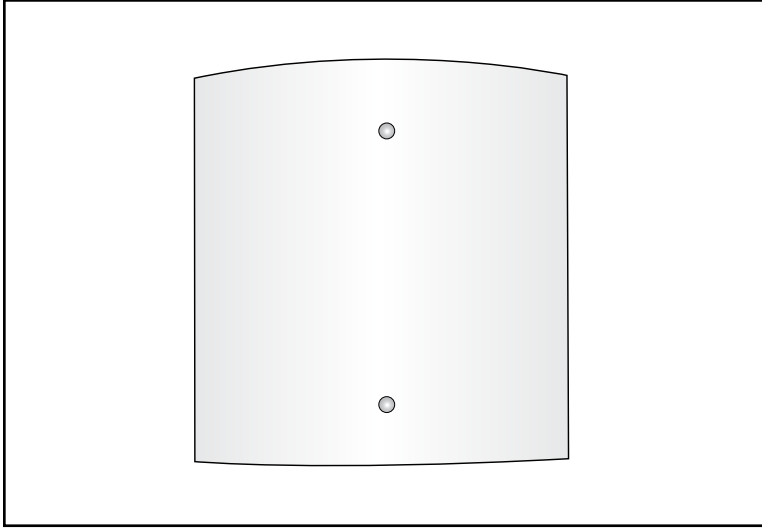

PROJECT: _____

LOCATION: _____

FEATURES

- Fascia constructed of 3/16" thick sandblasted acrylic, ensuring no lamp images.
- Contoured lens shields the lamps and melts into the décor.
- A wide choice of lamps can provide varying illumination levels.
- Unitized design allows the fixture to be used in even the most restrictive budgets.
- Standard 0-10V dimming driver.
- Meets ADA requirements.
- Manufactured in the U.S.A.

DIMENSIONS

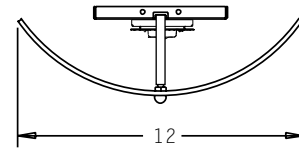
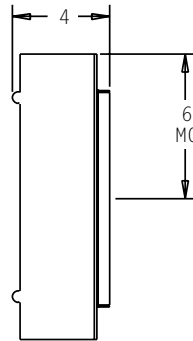
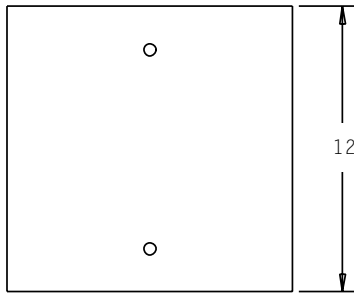

MC = Mounting Center
A 4" octagonal junction box should be used for installation.

ORDERING INFORMATION / OPTIONS EXAMPLE: 475-1LED19-BB

475

MODEL

475 - Altera

LAMP

- 1LED9** - (1) 9W LED MODULE. 1100 Lumens
- 1LED14** - (1) 14W LED MODULE. 1550 Lumens
- 1LED19** - (1) 19W LED MODULE. 2000 Lumens

HOUSING FINISH

- NA** - Natural Aluminum Ball
 - BB** - Brass Ball
 - PT** - Painted Ball (specify color)
- Consult factory for other finishes.*

OPTIONS

- TL** - Top Lens
- BL** - Bottom Lens
- MB** - Brushed Aluminum Middle Bar
- DL** - Damp Label
- 30K** - 3000 Kelvin Temperature
- 35K** - 3500 Kelvin Temperature
- 40K** - 4000 Kelvin Temperature